

AIR CLEANER LIGHT DISC Peterbilt 589

INSTALLATION INSTRUCTIONS:

1. Remove the air cleaner lid.
2. Set the light disc in position as shown below. The three flanges should be evenly spaced from the inner lip of the air cleaner intake screen and the outermost flange should be going outwards away from the truck.

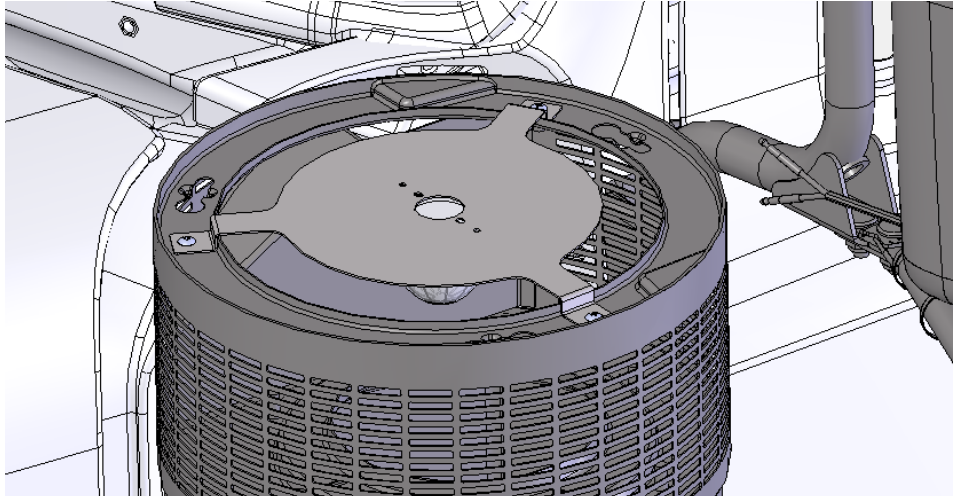

Figure 1: Driver Side Light Disc in Position (10742091 Shown)

3. If installing light discs with $\frac{3}{4}$ " round lights, ensure that one of the two grommet holes in the disc is aligned with the opening in the intake screen as this is where the wiring will pass through.

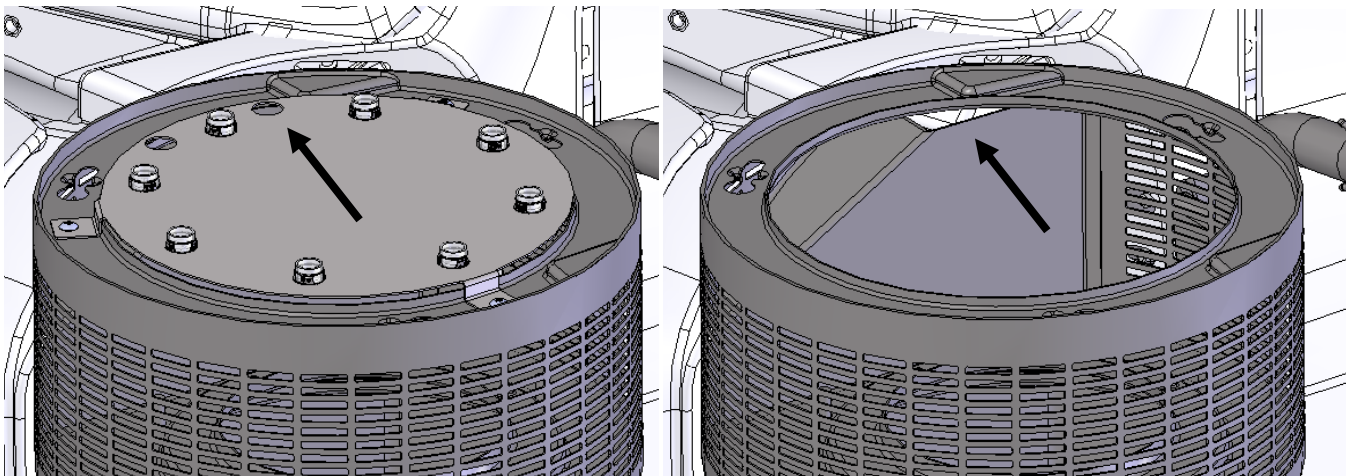

Figure 2: Grommet Hole (left) to be Aligned with Intake Screen Opening (right) for $\frac{3}{4}$ " Rd Light Disc

4. Mark the location of the three mounting slots and then set the light disc aside.
5. Remove the intake screen and then drill $\frac{19}{64}$ " holes in the marked locations.
6. Install the supplied 10-32 nutserts in each of the drilled holes. If using the supplied nutsert installation bar, it may need to be bent to allow it to sit flat within the channel of the intake screen.

7. Drill a 1 1/8" hole through the plastic panel that was behind the intake screen, the hole should be 3/4" down and 3/4" towards the cab from corner being pointed to in the figure below.

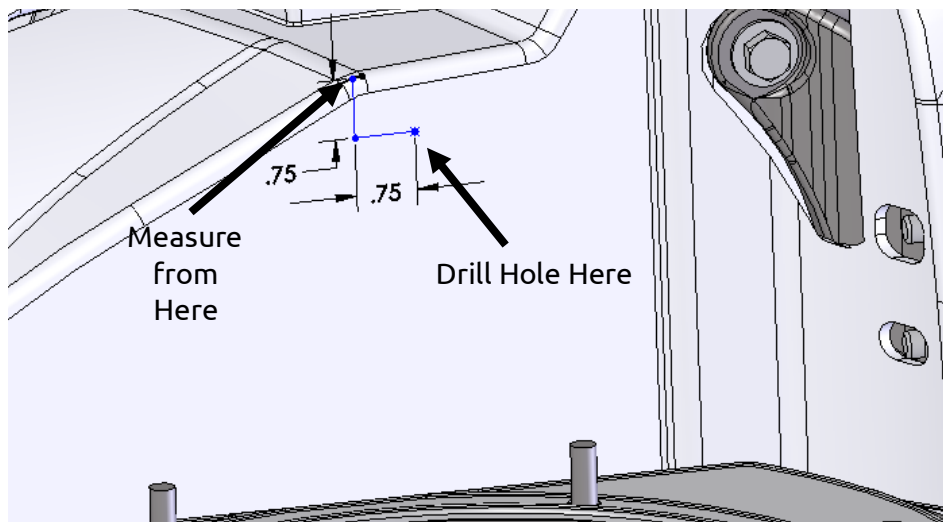

Figure 3: Hole to be Drilled for Wiring (Driver Side Shown)

8. Peel the protective plastic from the light disc.
9. For light discs with watermelon lights:
- Put the Metri-pack end of the supplied wiring harness through the hole drilled in Step 7.
 - Re-install the intake screen, bringing the female bullet plugs through the opening in the intake screen referenced in Figure 2.
 - Install the light disc onto the intake screen using the supplied 10-32x1/2" screws with external tooth lock washers.
 - Connect the harness to the light and use the supplied adhesive wire clips to secure the harness.
10. For light discs with 3/4" round lights:
- Install a grommet into the hole on the light disc that will be above the intake screen opening.
 - Put the Metri-pack end of the supplied wiring harness through the hole drilled in Step 7.
 - Re-install the intake screen, bringing the female bullet plugs through the opening in the intake screen referenced in Figure 2.
 - Route the female bullet plugs through the grommet in the light disc and then install the light disc onto the intake screen using the supplied 10-32x1/2" screws with external tooth lock washers.
 - Connect the routed harness to the pre-wired harness on the light disc. It is recommended to keep this connection easy to access as it will make removal of the light disc for future service easier.
11. Re-install the air cleaner lid.
12. The Metri-pack plugs brought into the engine bay will need to be connected to existing air cleaner lighting connections (if equipped) or another source of 12v fused power.